

GLOUCESTER COUNTY SURVEY MARK DATA SHEET

STATION NO.
005

HORIZONTAL DATA :		
VA. STATE PLANE COORD. - SOUTH ZONE (NAD 1983)		
UNITS	EASTING (X)	NORTHING (Y)
METERS	3662447.837	1137681.679
U.S. SURVEY FT.	12015880.945	3732543.975
LATITUDE (DMS)		37 33 35.00731
LONGITUDE (DMS)		76 39 40.36264
SCALE FACTOR		0.99995101
CONVERGENCE κ (DMS)		1 6 57.62
VERTICAL DATA :		
REF. TO NATL. GEOD. VERT. DATUM (1988)		
UNITS	STATION ELEVATION	
METERS	36.40	
U.S. SURVEY FT.	119.42	

STATION DESCRIPTION :

DISTRICT : PETSORTH

A 3-1/4" ALUMINUM DISK MONUMENT SET APPROXIMATELY FLUSH WITH THE GROUND STAMPED STATION NO. 005. TO REACH: FROM THE INTERSECTION OF U. S. ROUTE 17 AND STATE ROUTE 33 AT GLENN'S, GO ABOUT 2.8 MILES WEST ON STATE ROUTE 33 TO THE INTERSECTION OF STATE ROUTE 33 AND STATE ROUTE 609; GO ABOUT 0.15 MILE NORTH ON STATE ROUTE 609 TO MONUMENT SITE.

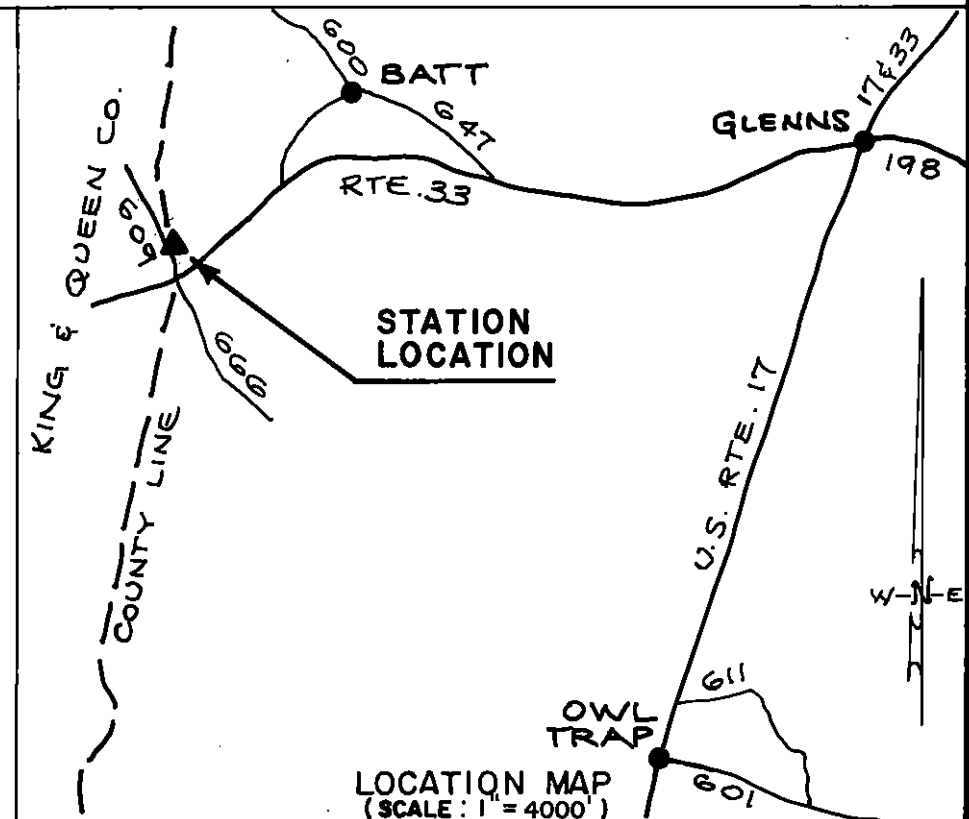
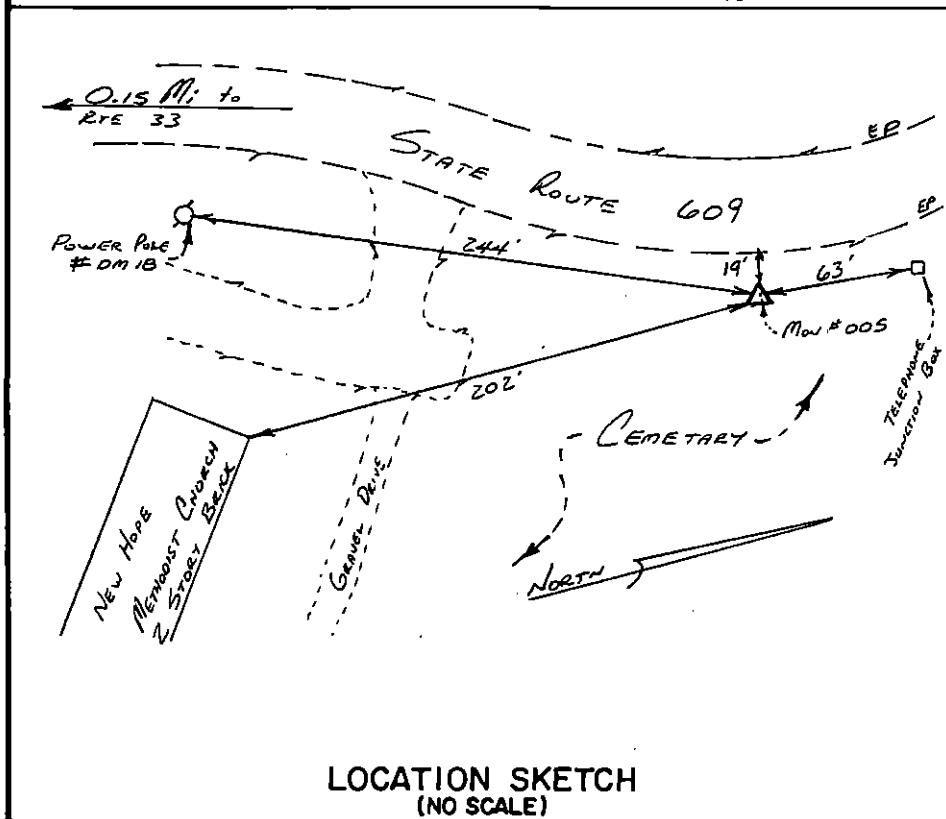

DATE: JANUARY, 1992

NOTE: USERS OF MONUMENTS LOCATED ON PRIVATE PROPERTY
MUST OBTAIN LAND OWNERS PERMISSION BEFORE ENTERING



DAWSON & PHILLIPS, P.C.
CERTIFIED LAND SURVEYORS
(804) 683-2983