

GLOUCESTER COUNTY SURVEY MARK DATA SHEET

STATION NO.
008

HORIZONTAL DATA :		
VA. STATE PLANE COORD. - SOUTH ZONE (NAD 1983)		
UNITS	EASTING (X)	NORTHING (Y)
METERS	3667634.554	1140068.505
U.S. SURVEY FT.	12032897.699	3740374.753
LATITUDE (DMS)		37 34 49.08496
LONGITUDE (DMS)		76 36 7.10833
SCALE FACTOR		0.99995228
CONVERGENCE \angle (DMS)		1 9 7.05
VERTICAL DATA :		
REF. TO NATL. GEOD. VERT. DATUM (1988)		
UNITS	STATION ELEVATION	
METERS	8.82	
U.S. SURVEY FT.	28.95	

STATION DESCRIPTION :

DISTRICT : PETSORTH

A 3-1/4" ALUMINUM DISK.. MONUMENT SET APPROXIMATELY FLUSH WITH THE GROUND STAMPED STATION NO. 008. TO REACH: FROM THE INTERSECTION OF U. S. ROUTE 17 AND STATE ROUTE 198 AT GLENNS, GO ABOUT 1.2 MILES NORTH ON U. S. ROUTE 17 TO MONUMENT SITE ON THE EAST SIDE OF U. S. ROUTE 17 AT ENTRANCE TO "BAREFORD'S LUMBER YARD".

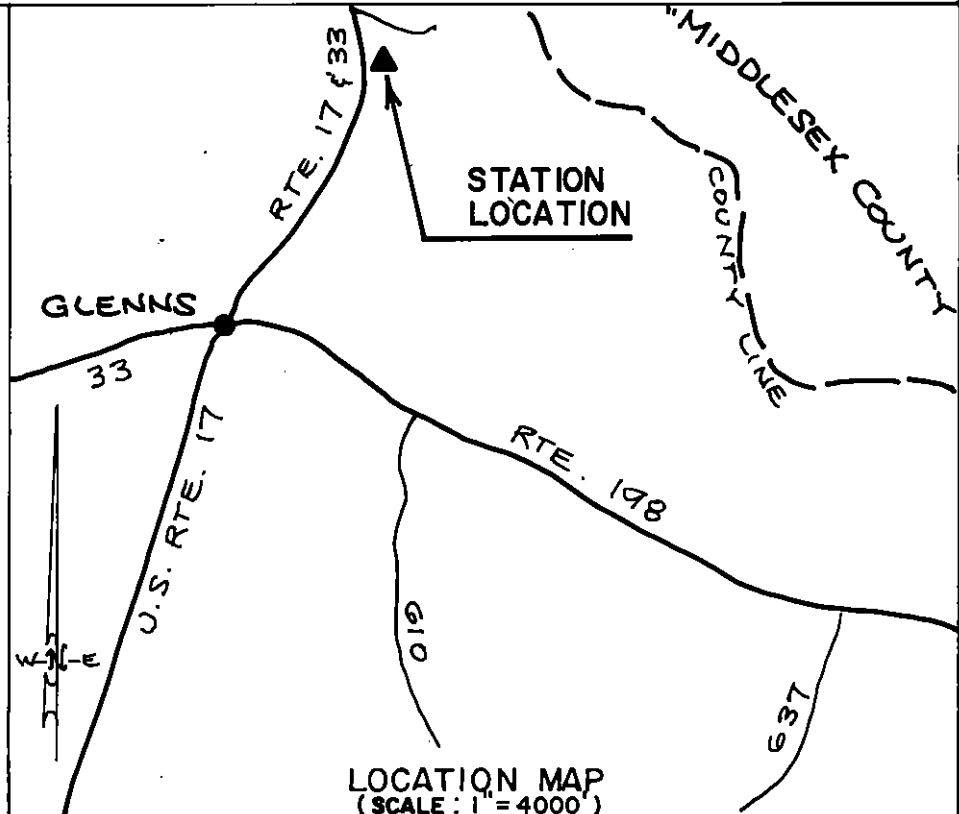
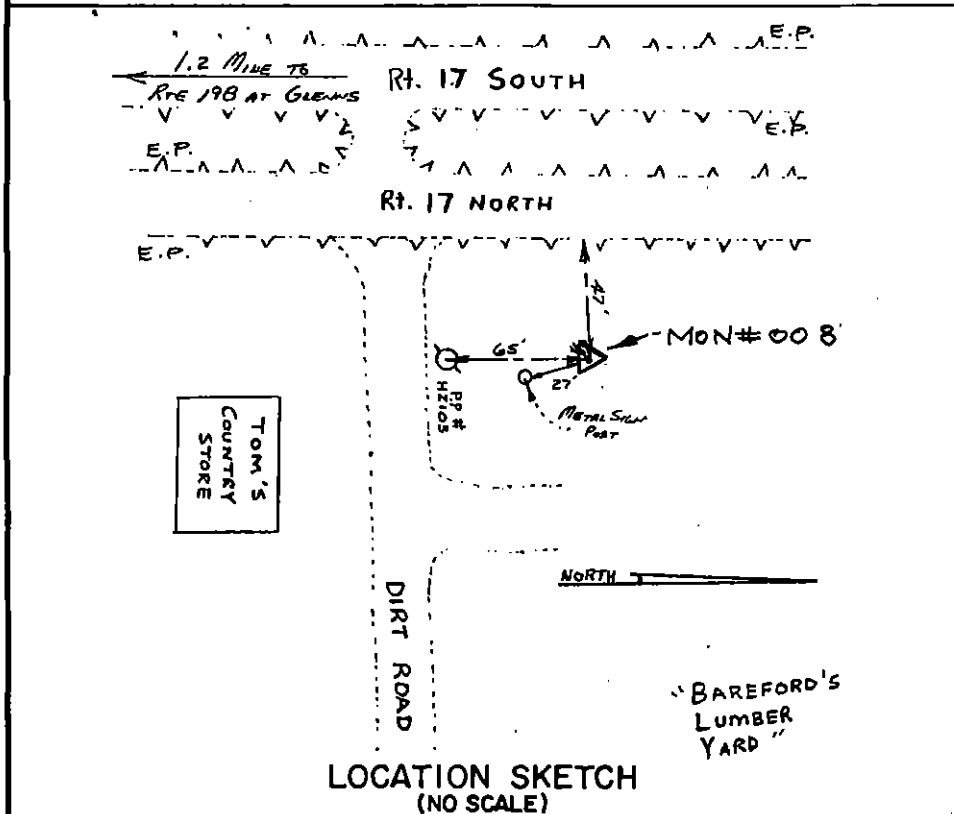

DATE: JANUARY, 1992

NOTE: USERS OF MONUMENTS LOCATED ON PRIVATE PROPERTY
MUST OBTAIN LAND OWNERS PERMISSION BEFORE ENTERING



DAWSON & PHILLIPS, P.C.
CERTIFIED LAND SURVEYORS
(004) 693-2993