

GLOUCESTER COUNTY SURVEY MARK DATA SHEET

STATION NO.
056

HORIZONTAL DATA : VA. STATE PLANE COORD. - SOUTH ZONE (NAD 1983)		
UNITS	EASTING (X)	NORTHING (Y)
METERS	3674833.349	1128883.393
U.S. SURVEY FT.	12056515.746	3703678.265
LATITUDE (DMS)		37 28 41.55001
LONGITUDE (DMS)		76 31 23.31060
SCALE FACTOR		0.99994726
CONVERGENCE \sphericalangle (DMS)		1 11 59.30
VERTICAL DATA : REF. TO NATL. GEOD. VERT. DATUM (1988)		
UNITS	STATION ELEVATION	
METERS	21.97	
U.S. SURVEY FT.	81.91	

STATION DESCRIPTION :

DISTRICT : PETERSWORTH

A 3-1/4" ALUMINUM DISK MONUMENT SET APPROXIMATELY FLUSH WITH THE GROUND STAMPED STATION NO. 056. TO REACH: FROM THE INTERSECTION OF STATE ROUTE 3 & 14 AND STATE ROUTE 604 AT WAN, GO ABOUT 1.0 MILE NORTH ON STATE ROUTE 604 TO INTERSECTION OF STATE ROUTE 605; GO ABOUT 3.64 MILES NORTH ON STATE ROUTE 605 TO MONUMENT SITE ON EAST SIDE OF STATE ROUTE 605.

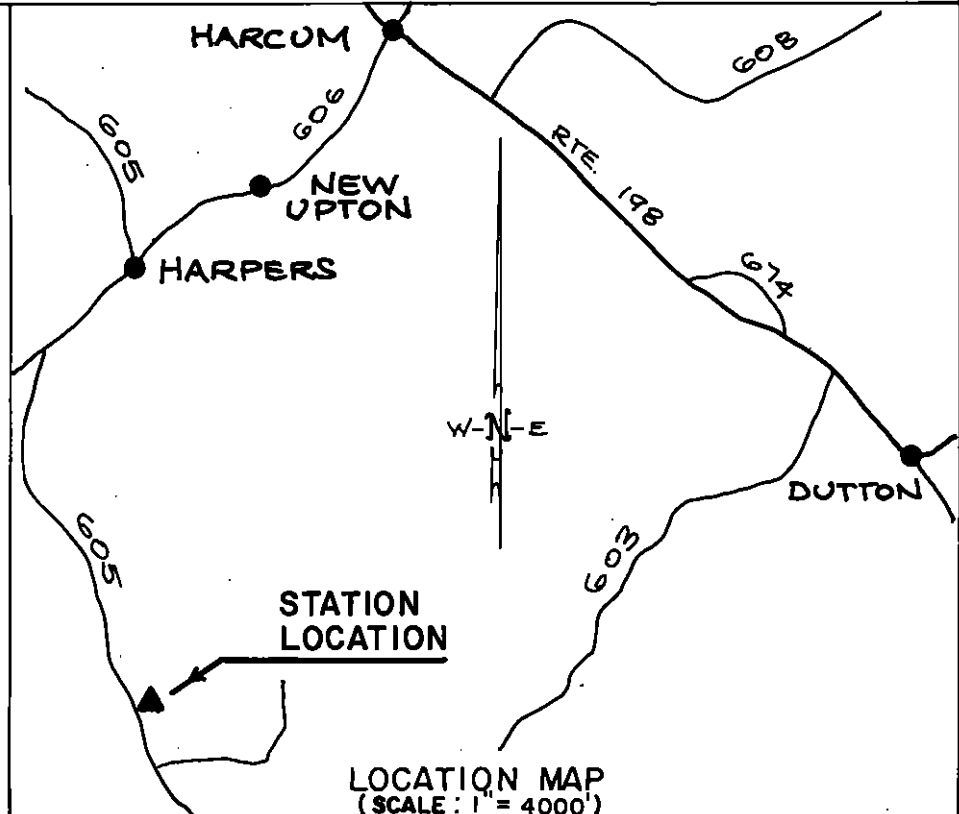
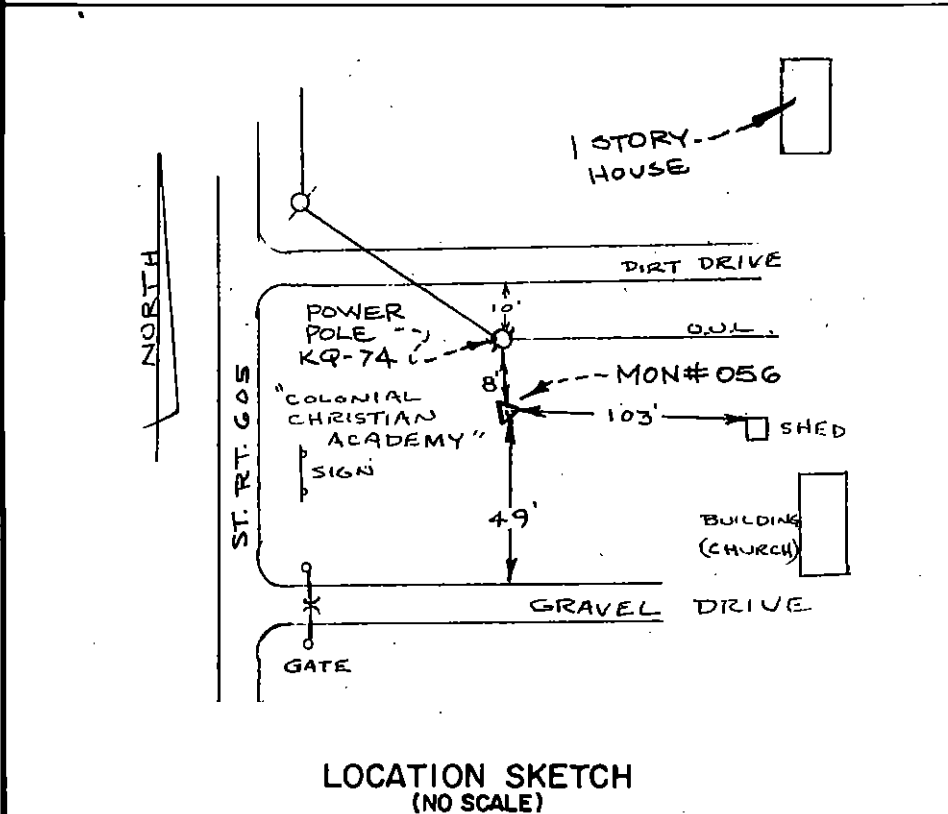

DATE: JANUARY, 1992

NOTE: USERS OF MONUMENTS LOCATED ON PRIVATE PROPERTY
MUST OBTAIN LAND OWNERS PERMISSION BEFORE ENTERING



DAWSON & PHILLIPS, D.C.
CERTIFIED LAND SURVEYORS
(804) 693-2993