

GLOUCESTER COUNTY SURVEY MARK DATA SHEET

STATION NO.
060A

HORIZONTAL DATA:

VA. STATE PLANE COORD.-SOUTH ZONE (NAD 1983)		
UNITS	EASTING (X)	NORTHING (Y)
METERS	3672969.992	1124585.665
U.S. SURVEY FT.	12050402.384	3689578.136
LATITUDE (DMS)	37°26'23.42837" N	
LONGITUDE (DMS)	76°32'42.75971" W	
SCALE FACTOR	0.99994620	
CONVERGENCE \sphericalangle (DMS)	01°11'11.08"	

STATION DESCRIPTION:

DISTRICT: WARE

A 3-1/4" ALUMINUM DISK MONUMENT SET APPROXIMATELY FLUSH WITH THE GROUND STAMPED STATION NO. 060A. TO REACH: FROM THE INTERSECTION OF U.S. ROUTE 17 AND STATE ROUTE 606 AT ARK, GO ABOUT 1.7 MILES SOUTHEAST ON U.S. ROUTE 17 TO INTERSECTION WITH "SPRING HILL FARM" ROAD (A PRIVATE GRAVEL ROAD); GO ABOUT 0.2 MILE NORTHEAST ON PRIVATE ROAD TO FORK IN ROAD; PROCEED ON LEFT (NORTHEAST) BRANCH OF PRIVATE ROAD ABOUT 0.80 MILE TO MONUMENT AT COUNTY WATER TREATMENT PLANT ON BEAVERDAM RESERVOIR.

VERTICAL DATA:

REF. TO NATL. GEOD. VERT. DATUM (1988)	
UNITS	STATION ELEVATION
METERS	17.97
U.S. SURVEY FT.	58.96

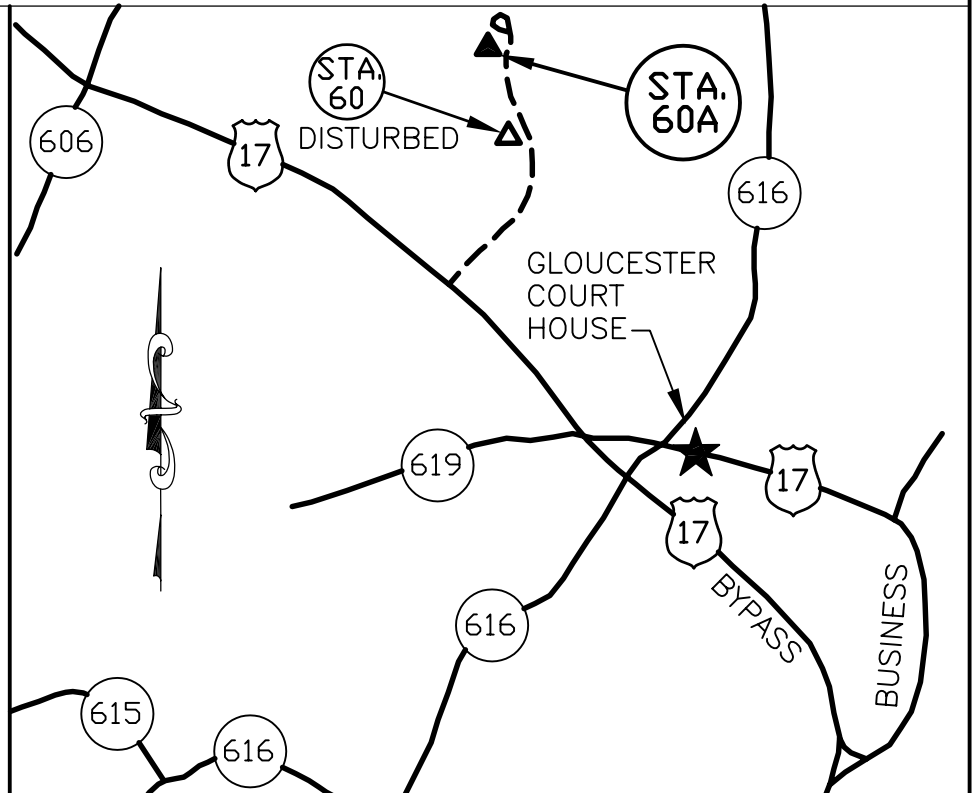
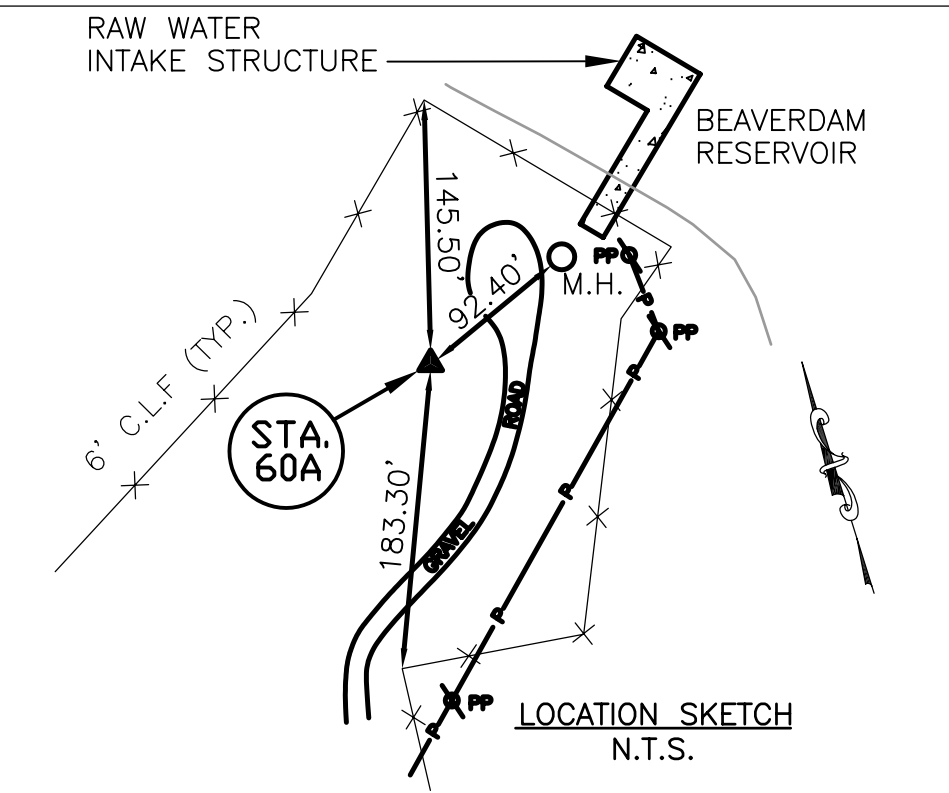

G.P.S. DATA FOR STATION 60A PROVIDED BY:
THOMAS LAND SURVEYING, P.C.
 11830-A CANON BLVD., NEWPORT NEWS, VA. 23606

AD POTTIS & ASSOCIATES, INC.
 11524 JEFFERSON AVENUE
 NEWPORT NEWS, VIRGINIA 23601
 PHONE: (757) 595-4610