

GLOUCESTER COUNTY SURVEY MARK DATA SHEET

STATION NO.
062

HORIZONTAL DATA :		
VA. STATE PLANE COORD. - SOUTH ZONE (NAD 1983)		
UNITS	EASTING (X)	NORTHING (Y)
METERS	3671487.223	1121666.474
U.S. SURVEY FT.	12045537.664	3680000.757
LATITUDE (DMS)		37 24 49.74614
LONGITUDE (DMS)		76 33 45.50578
SCALE FACTOR		0.99994573
CONVERGENCE \sphericalangle (DMS)		1 10 32.99
VERTICAL DATA :		
REF. TO NATL. GEOD. VERT. DATUM (1988)		
UNITS	STATION ELEVATION	
METERS	21.22	
U.S. SURVEY FT.	69.63	

STATION DESCRIPTION :

DISTRICT : WARE

A 3-1/4" ALUMINUM DISK MONUMENT SET APPROXIMATELY FLUSH WITH THE GROUND STAMPED STATION NO. 062. TO REACH: FROM THE INTERSECTION OF U. S. ROUTE 17 AND STATE ROUTE 619, GO ABOUT 1.2 MILES WEST ON STATE ROUTE 619 TO MONUMENT SITE.

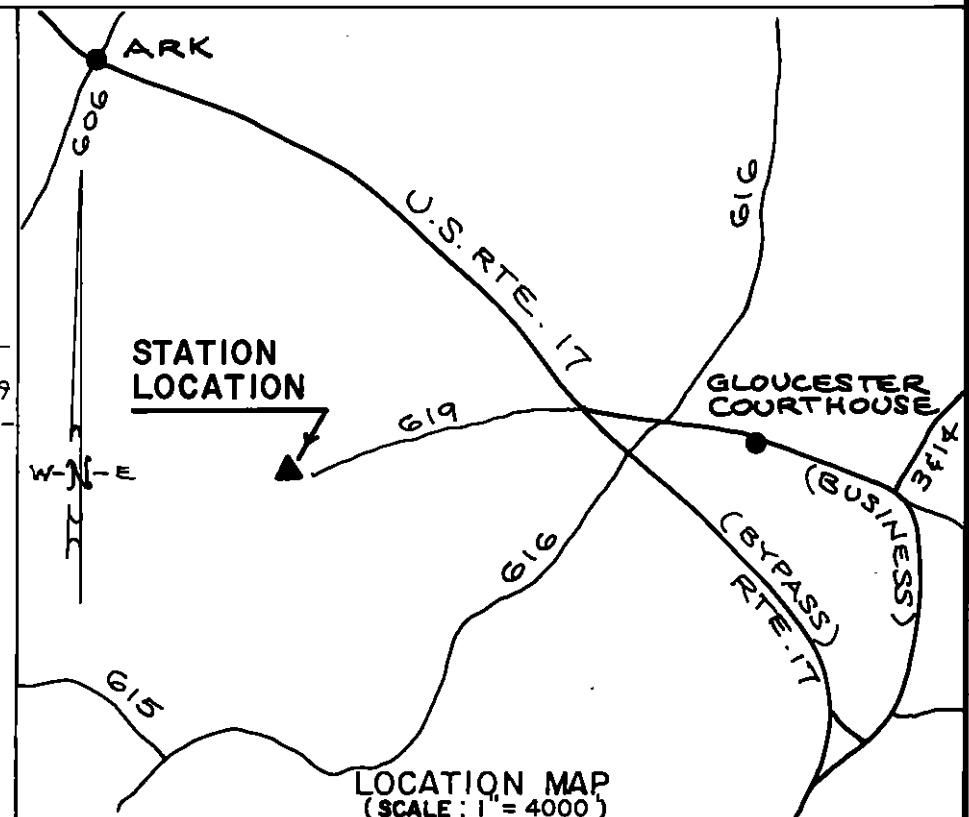
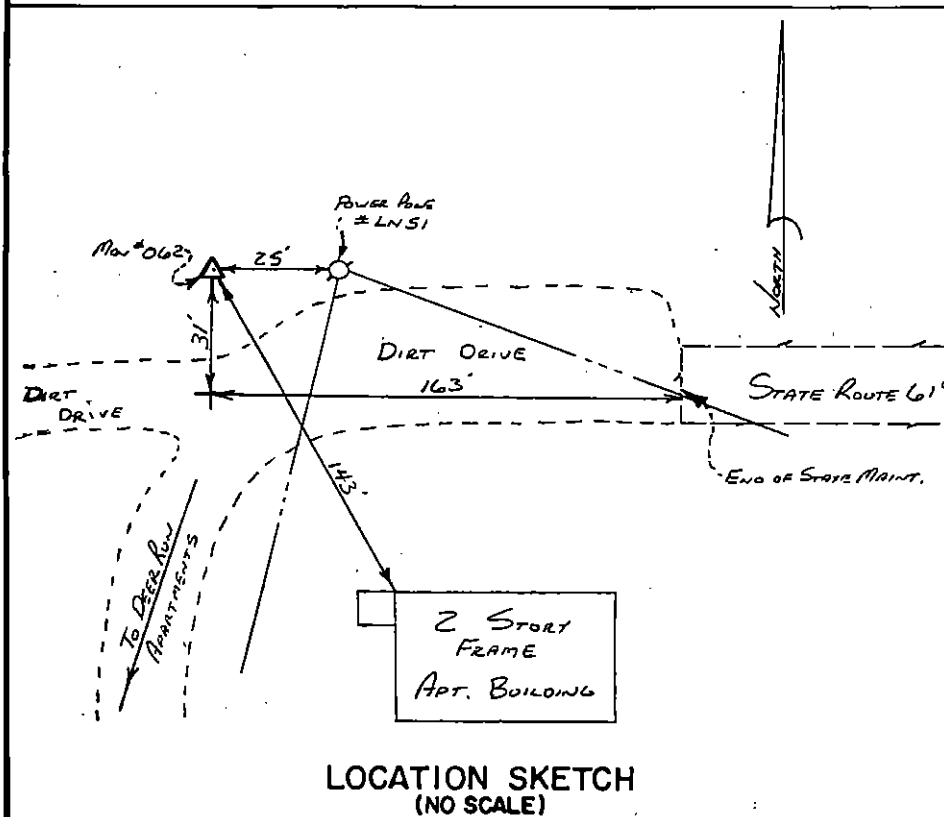

DATE: JANUARY, 1992

NOTE: USERS OF MONUMENTS LOCATED ON PRIVATE PROPERTY
MUST OBTAIN LAND OWNERS PERMISSION BEFORE ENTERING



DAWSON & PHILLIPS, D.C.
CERTIFIED LAND SURVEYORS
(804) 693-2993