

GLOUCESTER COUNTY SURVEY MARK DATA SHEET

STATION NO.
064

HORIZONTAL DATA :		
VA. STATE PLANE COORD. - SOUTH ZONE (NAD 1983)		
UNITS	EASTING (X)	NORTHING (Y)
METERS	3668121.404	1117830.883
U.S. SURVEY FT.	12034494.973	3667416.822
LATITUDE (DMS)	37 22 47.56880	
LONGITUDE (DMS)	76 36 5.49517	
SCALE FACTOR	0.99994542	
CONVERGENCE ϵ (DMS)	1 9 8.03	
VERTICAL DATA :		
REF. TO NATL. GEOD. VERT. DATUM (1988)		
UNITS	STATION ELEVATION	
METERS	16.46	
U.S. SURVEY FT.	53.99	

STATION DESCRIPTION :

DISTRICT : PETERSWORTH

A 3-1/4" ALUMINUM DISK MONUMENT SET APPROXIMATELY FLUSH WITH THE GROUND STAMPED STATION NO. 064. TO REACH: FROM THE INTERSECTION OF STATE ROUTE 606 AND STATE ROUTE 614 AT SASSAFRAS, GO ABOUT 1.1 MILES SOUTHEAST ON STATE ROUTE 614 TO DIRT LANE ON SOUTHWEST SIDE OF STATE ROUTE 614; GO ABOUT 1.1 MILES ON DIRT LANE PAST CAMPGROUND TO MONUMENT SITE ON WEST SIDE OF DIRT LANE.

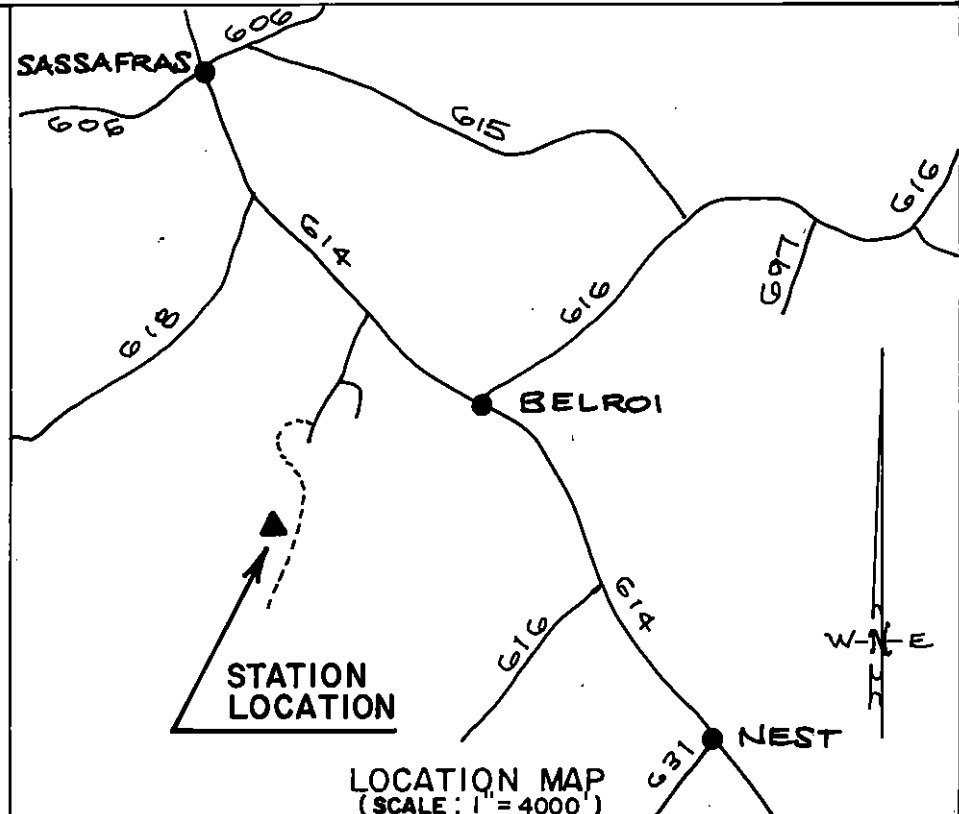
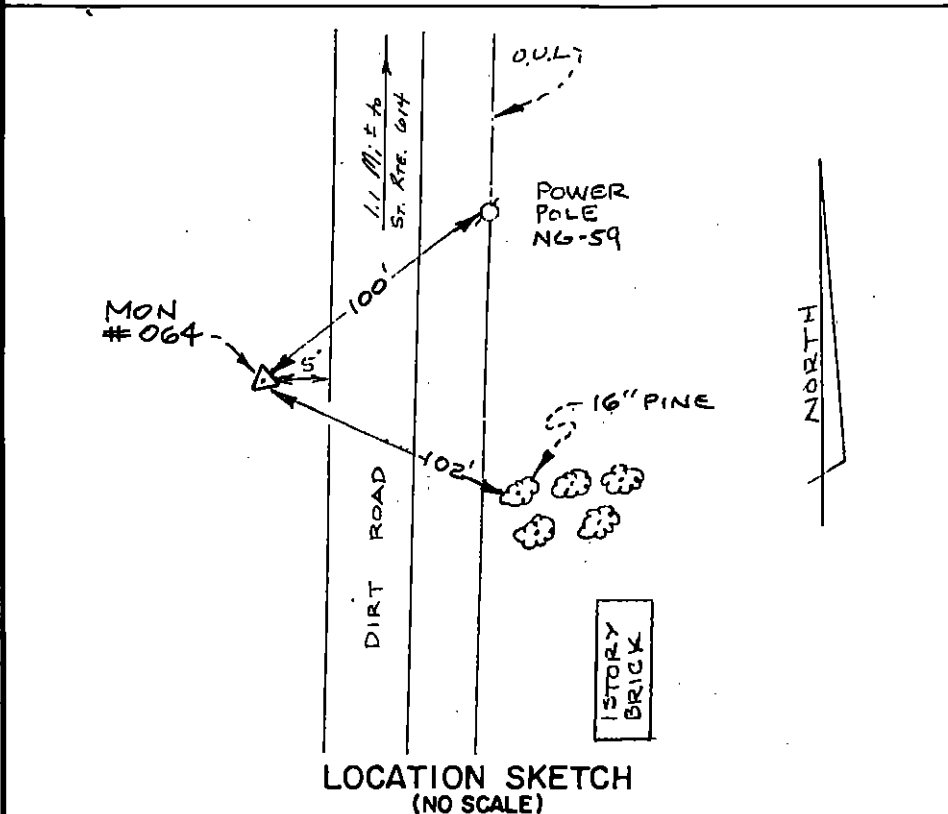

DATE: JANUARY, 1992

NOTE: USERS OF MONUMENTS LOCATED ON PRIVATE PROPERTY
MUST OBTAIN LAND OWNERS PERMISSION BEFORE ENTERING



DAWSON & PHILLIPS, P.C.
CERTIFIED LAND SURVEYORS
(804) 693-2993