

# GLOUCESTER COUNTY SURVEY MARK DATA SHEET

**STATION NO.**  
065

<b>HORIZONTAL DATA :</b> VA. STATE PLANE COORD. - SOUTH ZONE (NAD 1983)		
UNITS	EASTING (X)	NORTHING (Y)
METERS	3667598.096	1114493.393
U.S. SURVEY FT.	12032778.087	3666467.074
LATITUDE (DMS)	37 20 59.66792	
LONGITUDE (DMS)	76 36 29.48164	
SCALE FACTOR	0.99994545	
CONVERGENCE $\sphericalangle$ (DMS)	1 8 53.47	
<b>VERTICAL DATA :</b> REF. TO NATL. GEOD. VERT. DATUM (1988)		
UNITS	STATION ELEVATION	
METERS	2.41	
U.S. SURVEY FT.	7.90	

**STATION DESCRIPTION :**

**DISTRICT :** PETSORTH

A 3-1/4" ALUMINUM DISK MONUMENT SET APPROXIMATELY FLUSH WITH THE GROUND STAMPED STATION NO. 065. TO REACH: FROM THE INTERSECTION OF U. S. ROUTE 17 AND STATE ROUTE 614 AT WHITE MARSH, GO ABOUT 4.2 MILES NORTHWEST ON STATE ROUTE 614 TO THE INTERSECTION OF STATE ROUTE 614 AND STATE ROUTE 616; CONTINUE ABOUT 2.5 MILES SOUTHWEST ON STATE ROUTE 616 TO MONUMENT SITE.

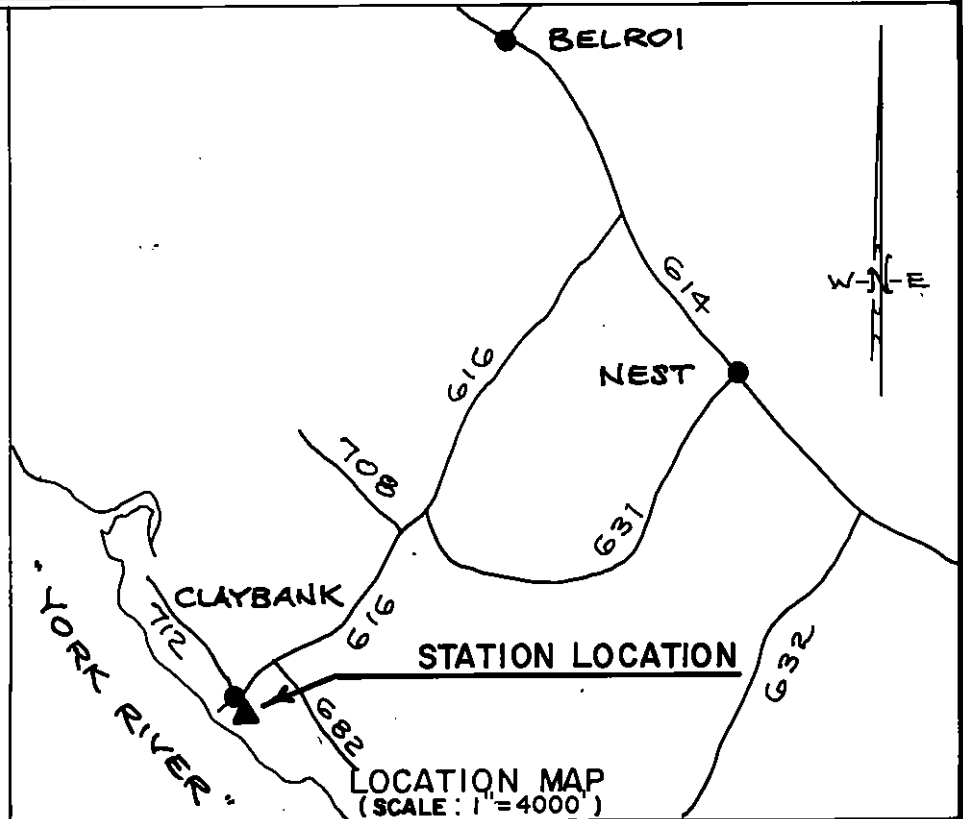
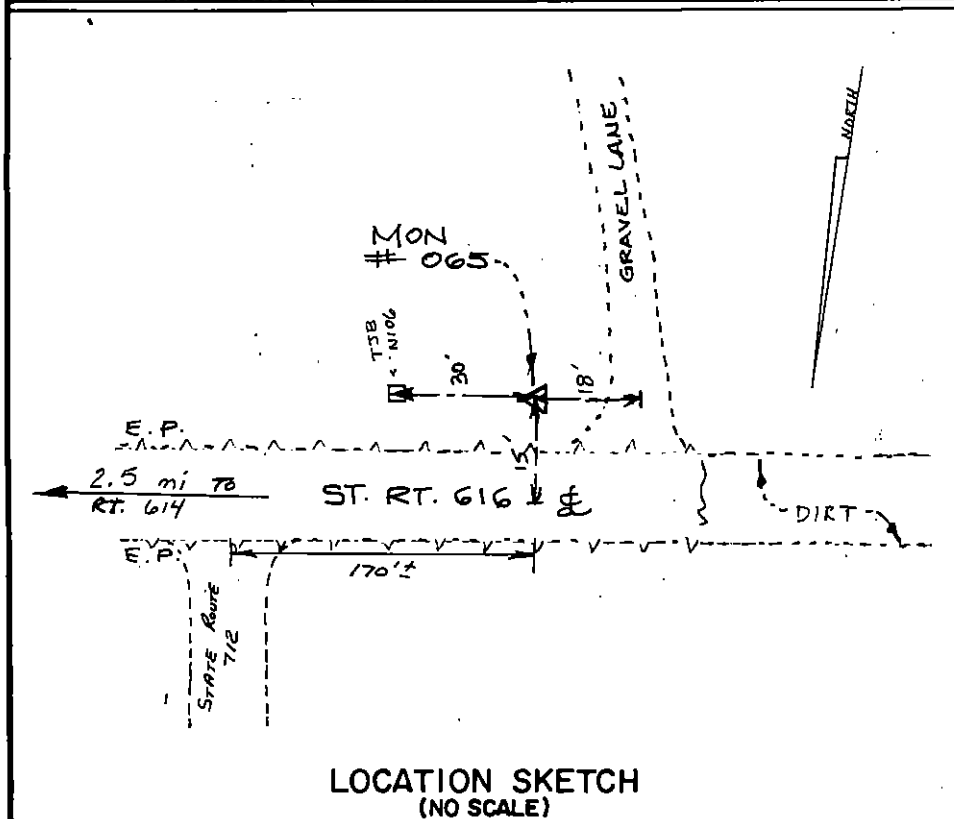

DATE: JANUARY, 1992

NOTE: USERS OF MONUMENTS LOCATED ON PRIVATE PROPERTY  
MUST OBTAIN LAND OWNERS PERMISSION BEFORE ENTERING



**DANSON & PHILLIPS, P.C.**

CERTIFIED LAND SURVEYORS  
(804) 693-2993