

GLOUCESTER COUNTY SURVEY MARK DATA SHEET

STATION NO.
066

HORIZONTAL DATA :		
VA. STATE PLANE COORD. - SOUTH ZONE (NAD 1983)		
UNITS	EASTING (X)	NORTHING (Y)
METERS	3668672.651	1115557.037
U.S. SURVEY FT.	12036303.522	3659956.712
LATITUDE (DMS)		37 21 33.46301
LONGITUDE (DMS)		76 35 44.95612
SCALE FACTOR		0.99994541
CONVERGENCE \sphericalangle (DMS)		1 9 20.50
VERTICAL DATA :		
REF. TO NATL. GEOD. VERT. DATUM (1988)		
UNITS	STATION ELEVATION	
METERS	9.29	
U.S. SURVEY FT.	30.47	

STATION DESCRIPTION :

DISTRICT : PETSORTH

A 3-1/4" ALUMINUM DISK MONUMENT SET APPROXIMATELY FLUSH WITH THE GROUND STAMPED STATION NO. 066. TO REACH: FROM THE INTERSECTION OF U. S. ROUTE 17 AND STATE ROUTE 614 AT WHITE MARSH, GO ABOUT 4.2 MILES WEST ON STATE ROUTE 614 TO THE INTERSECTION OF STATE ROUTE 614 AND STATE ROUTE 616; GO ABOUT 1.6 MILES SOUTH ON STATE ROUTE 616 TO MONUMENT SITE.

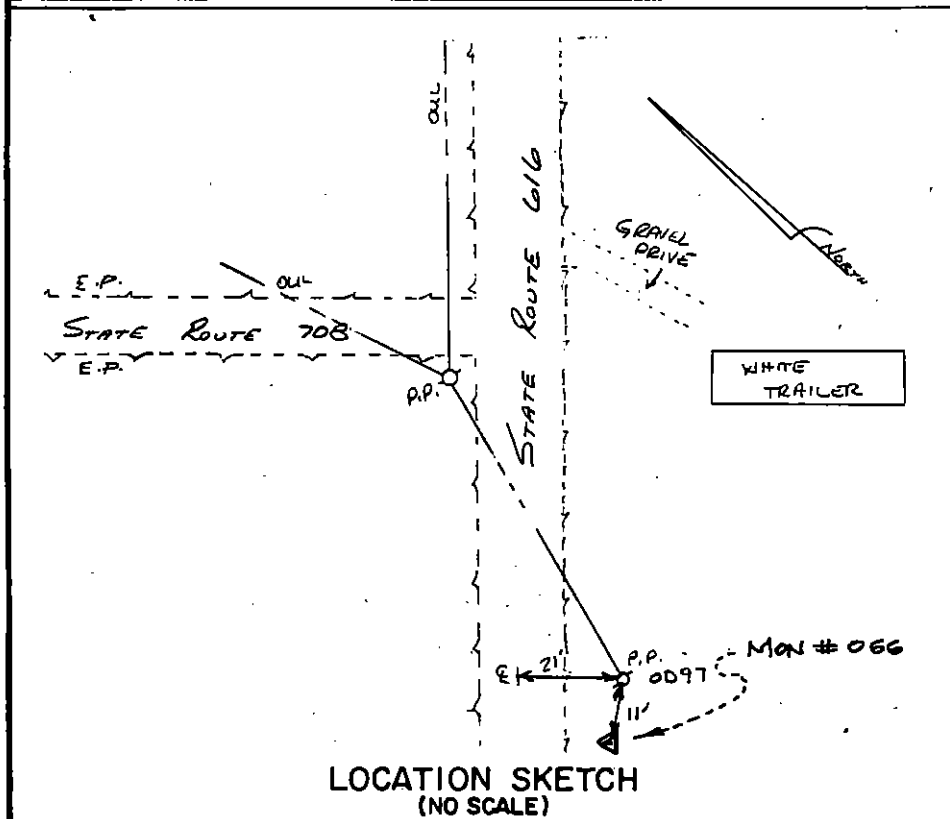

LOCATION SKETCH
(NO SCALE)

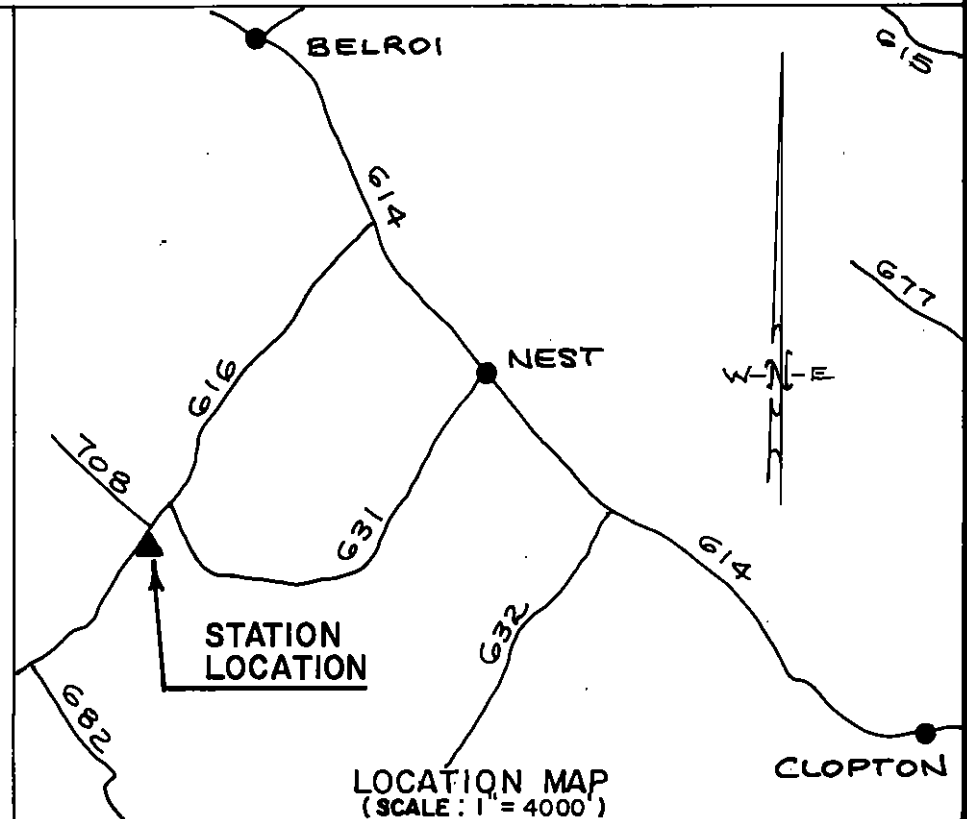

LOCATION MAP
(SCALE: 1" = 4000')

DATE: JANUARY, 1992

NOTE: USERS OF MONUMENTS LOCATED ON PRIVATE PROPERTY
MUST OBTAIN LAND OWNERS PERMISSION BEFORE ENTERING



DANBON & PHILLIPS, P.C.
CERTIFIED LAND SURVEYORS
(804) 683-2993