

# GLOUCESTER COUNTY SURVEY MARK DATA SHEET

**STATION NO.**  
067

<b>HORIZONTAL DATA :</b>		
VA. STATE PLANE COORD. - SOUTH ZONE (NAD 1983)		
UNITS	EASTING (X)	NORTHING (Y)
METERS	3670073.852	1117723.254
U.S. SURVEY FT.	12040900.629	3667063.709
LATITUDE (DMS)		37 22 42.79720
LONGITUDE (DMS)		76 34 46.23466
SCALE FACTOR		0.99994542
CONVERGENCE $\sphericalangle$ (DMS)		1 9 56.14
<b>VERTICAL DATA :</b>		
REF. TO NATL. GEOD. VERT. DATUM (1988)		
UNITS	STATION ELEVATION	
METERS	27.06	
U.S. SURVEY FT.	88.78	

**STATION DESCRIPTION :**

**DISTRICT :** PETSORTH

A 3-1/4" ALUMINUM DISK MONUMENT SET APPROXIMATELY FLUSH WITH THE GROUND STAMPED STATION NO. 067. TO REACH: FROM THE INTERSECTION OF STATE ROUTE 614 AND STATE ROUTE 616 AT BELROI, GO ABOUT 0.8 MILE SOUTHEAST ON STATE ROUTE 614 TO GRAVEL DRIVE AND MONUMENT SITE.

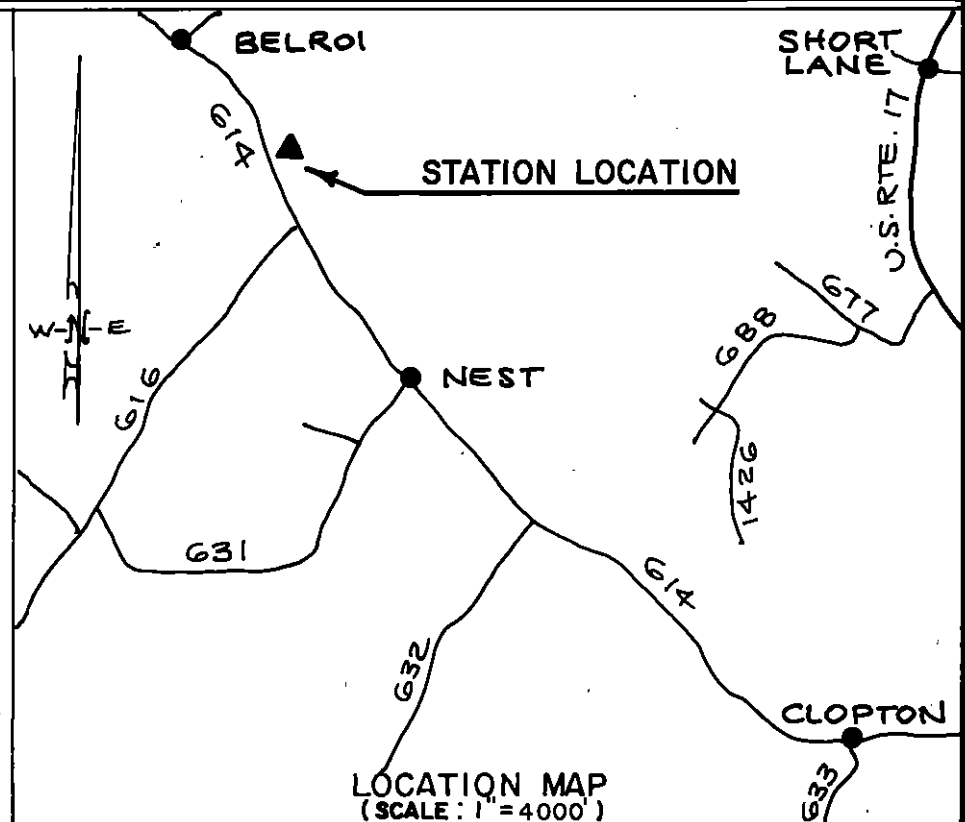
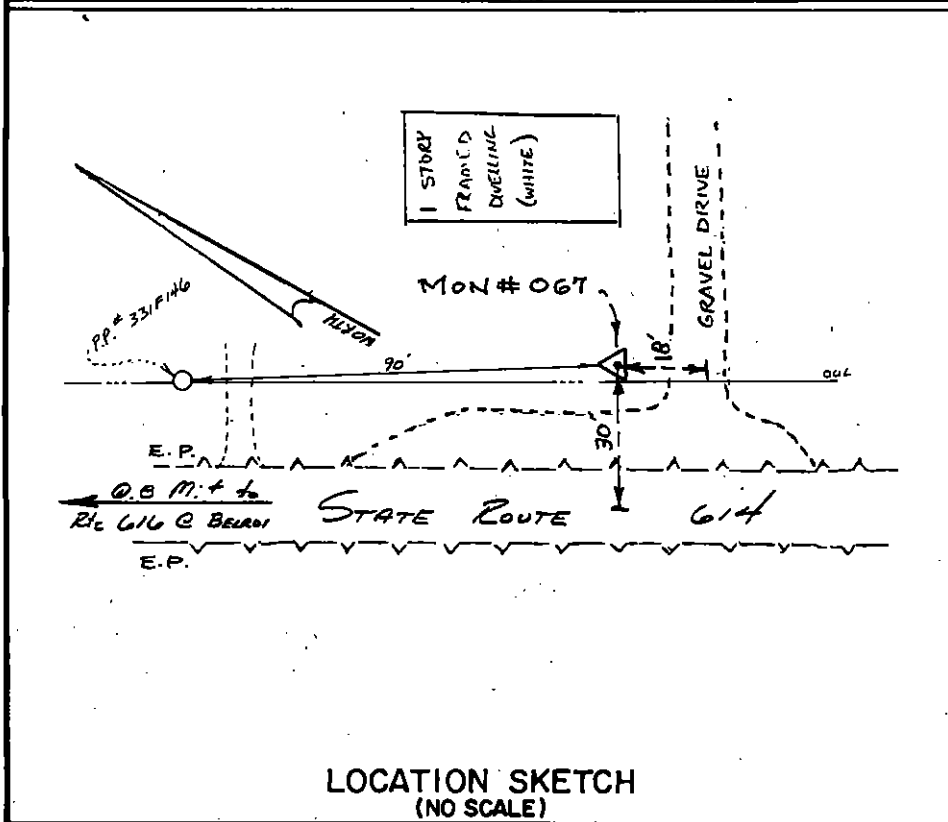

DATE: JANUARY, 1992

NOTE: USERS OF MONUMENTS LOCATED ON PRIVATE PROPERTY  
MUST OBTAIN LAND OWNERS PERMISSION BEFORE ENTERING



**DAWSON & PHILLIPS, P.C.**  
CERTIFIED LAND SURVEYORS  
(004) 693-2993