

GLOUCESTER COUNTY SURVEY MARK DATA SHEET

STATION NO.
159

HORIZONTAL DATA : VA. STATE PLANE COORD. - SOUTH ZONE (NAD 1983)		
UNITS	EASTING (X)	NORTHING (Y)
METERS	3675491.723	1109753.032
U.S. SURVEY FT.	12058675.761	3640914.739
LATITUDE (DMS)		37 18 20.67719
LONGITUDE (DMS)		76 31 12.84719
SCALE FACTOR		0.99994598
CONVERGENCE \sphericalangle (DMS)		1 12 5.65
VERTICAL DATA : REF. TO NATL. GEOD. VERT. DATUM (1988)		
UNITS	STATION ELEVATION	
METERS	11.07	
U.S. SURVEY FT.	36.32	

STATION DESCRIPTION :

DISTRICT : ABINGDON

A 3-1/4" ALUMINUM DISK MONUMENT SET APPROXIMATELY FLUSH WITH THE GROUND STAMPED STATION NO. 159. TO REACH: FROM THE INTERSECTION OF U. S. ROUTE 17 AND STATE ROUTE 636 AT ORDINARY, GO ABOUT 0.8 MILE SOUTH ON U. S. ROUTE 17 TO THE INTERSECTION OF STATE ROUTE 1306; GO ABOUT 0.45 MILE WEST ON STATE ROUTE 1306 TO END OF STATE MAINTENANCE AND A DIRT ROAD; MONUMENT IS APPROXIMATELY 85' NORTH OF INTERSECTION OF STATE ROUTE 1306 AND DIRT ROAD.

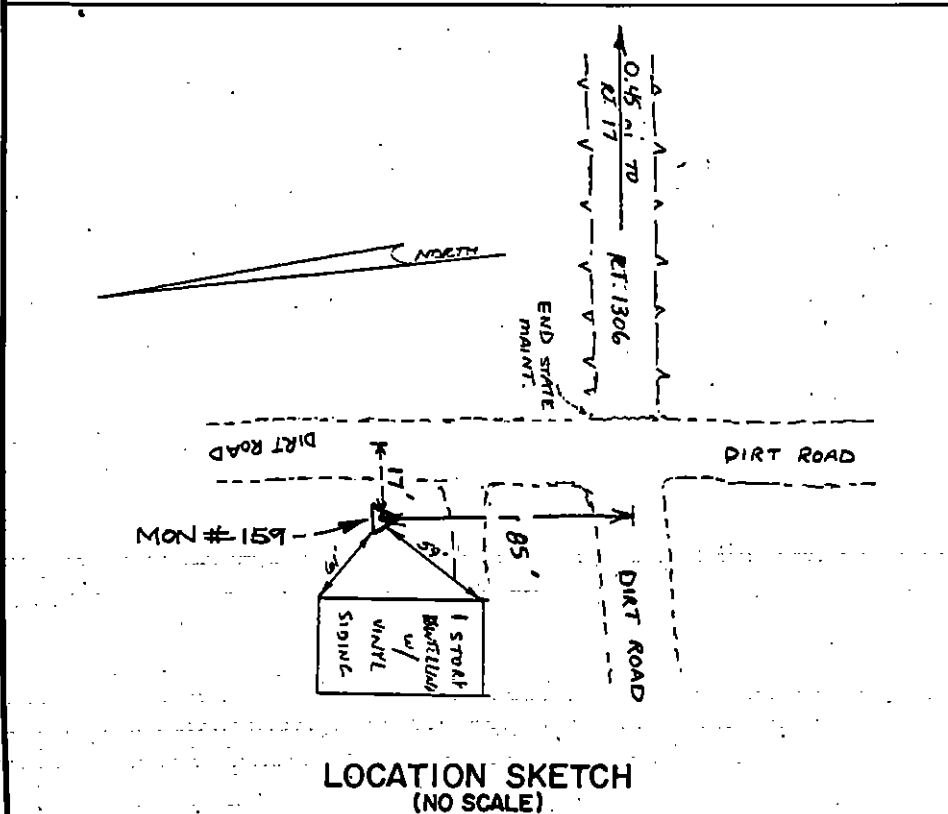

LOCATION SKETCH
(NO SCALE)

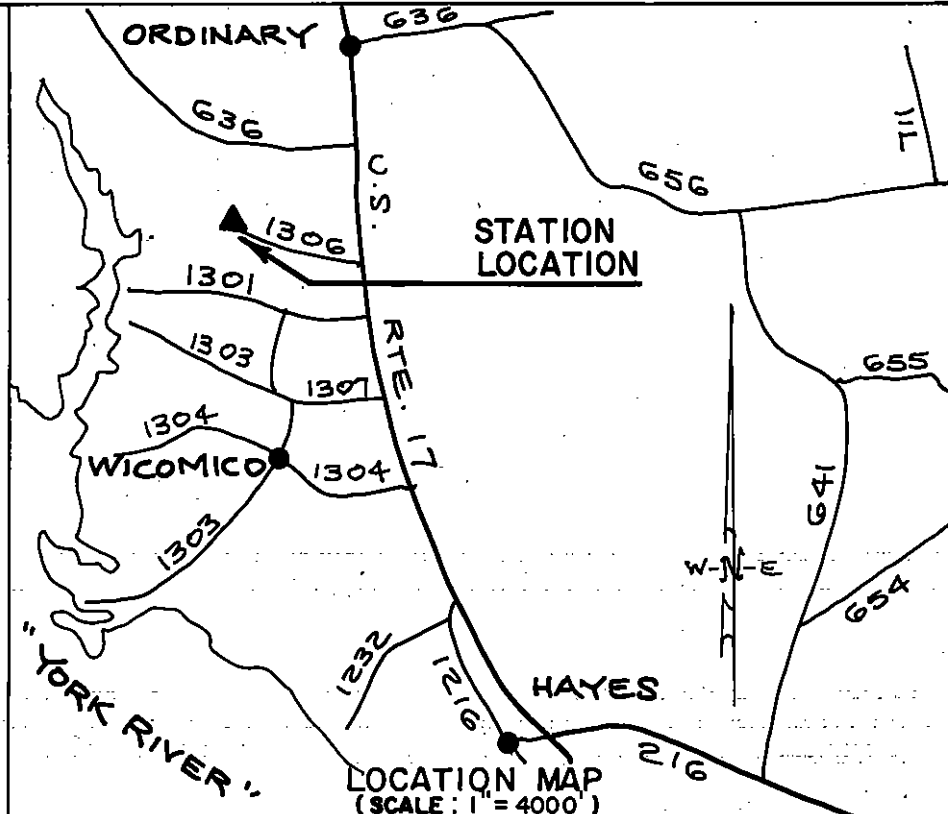

LOCATION MAP
(SCALE: 1" = 4000')

DATE: JANUARY, 1992

NOTE: USERS OF MONUMENTS LOCATED ON PRIVATE PROPERTY
MUST OBTAIN LAND OWNERS PERMISSION BEFORE ENTERING



DAWSON & PHILLIPS, D.C.
CERTIFIED LAND SURVEYORS
(804) 693-2993