

GLOUCESTER COUNTY SURVEY MARK DATA SHEET

STATION NO.
160

HORIZONTAL DATA : VA. STATE PLANE COORD. - SOUTH ZONE (NAD 1983)		
UNITS	EASTING (X)	NORTHING (Y)
METERS	3676155.667	1109269.372
U.S. SURVEY FT.	12060854.051	3639327.931
LATITUDE (DMS)		37 18 4.53871
LONGITUDE (DMS)		76 30 46.30412
SCALE FACTOR		0.99994607
CONVERGENCE κ (DMS)		1 12 21.76
VERTICAL DATA : REF. TO NATL. GEOD. VERT. DATUM (1988)		
UNITS	STATION ELEVATION	
METERS	11.88	
U.S. SURVEY FT.	38.96	

STATION DESCRIPTION :

DISTRICT : ABINGDON

A 3-1/4" ALUMINUM DISK MONUMENT SET APPROXIMATELY FLUSH WITH THE GROUND STAMPED STATION NO. 160. TO REACH: FROM THE INTERSECTION OF U. S. ROUTE 17 AND STATE ROUTE 636 AT ORDINARY, GO ABOUT 1.05 MILES SOUTH ON U. S. ROUTE 17 TO INTERSECTION WITH STATE ROUTE 1301; GO ABOUT 0.03 MILE WEST ON STATE ROUTE 1301 TO MONUMENT SITE ON SOUTH SIDE OF STATE ROUTE 1301.

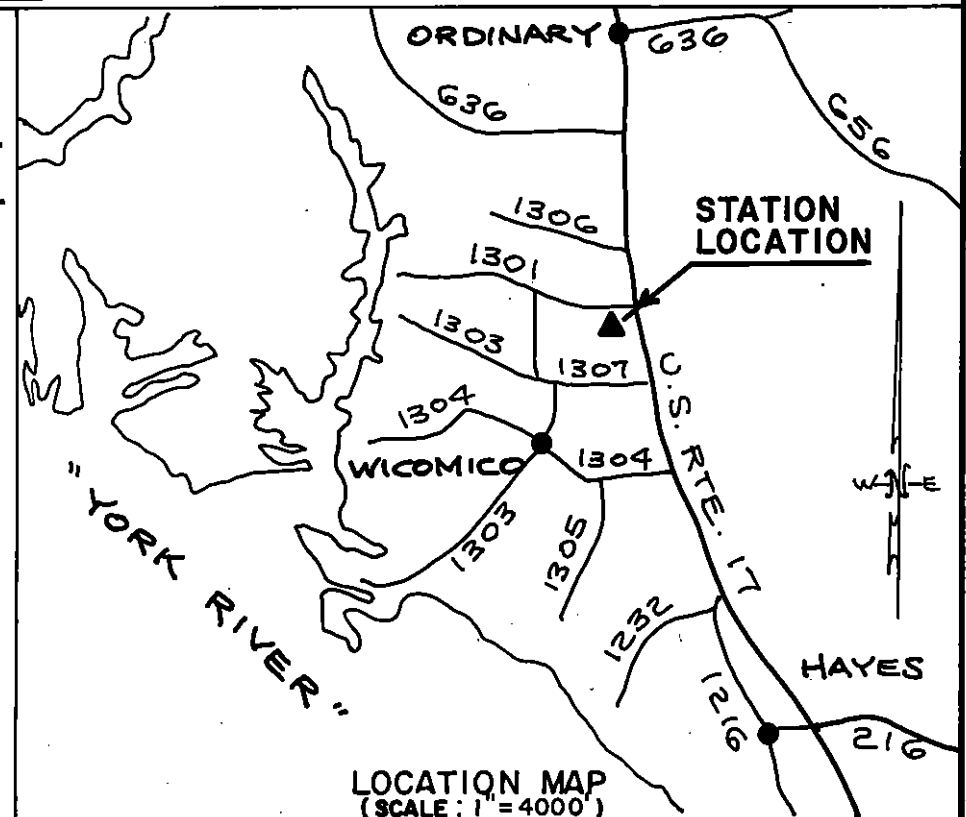
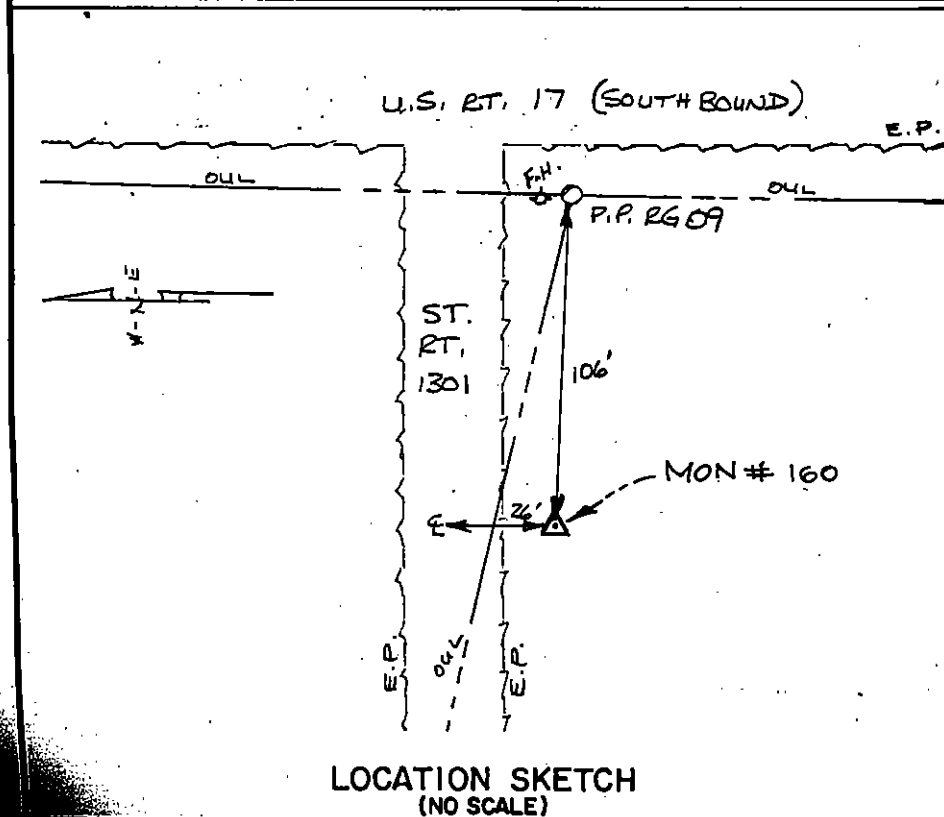

JANUARY, 1992

NOTE: USERS OF MONUMENTS LOCATED ON PRIVATE PROPERTY
MUST OBTAIN LAND OWNERS PERMISSION BEFORE ENTERING



DAWSON & PHILLIPS, D.C.
CERTIFIED LAND SURVEYORS
(804) 693-2993