

GLOUCESTER COUNTY SURVEY MARK DATA SHEET

STATION NO.
161

HORIZONTAL DATA :		
VA. STATE PLANE COORD. - SOUTH ZONE (NAD 1983)		
UNITS	EASTING (X)	NORTHING (Y)
METERS	3675615.713	1109262.246
U.S. SURVEY FT.	1205009.743	363904.552
LATITUDE (DMS)	37 18 4.68250	
LONGITUDE (DMS)	76 31 8.63732	
SCALE FACTOR	0.99994607	
CONVERGENCE κ (DMS)	1 12 8.20	
VERTICAL DATA :		
REF. TO NATL. GEOD. VERT. DATUM (1988)		
UNITS	STATION ELEVATION	
METERS	12.45	
U.S. SURVEY FT.	40.84	

STATION DESCRIPTION :

DISTRICT : ABINGDON

A 3-1/4" ALUMINUM DISK MONUMENT SET APPROXIMATELY FLUSH WITH THE GROUND STAMPED STATION NO. 161. TO REACH: FROM THE INTERSECTION OF U. S. ROUTE 17 AND STATE ROUTE 636 AT ORDINARY, GO ABOUT 1.04 MILES SOUTH ON U. S. ROUTE 17 TO THE INTERSECTION OF U. S. ROUTE 17 AND STATE ROUTE 1301; GO ABOUT 0.38 MILE WEST ON STATE ROUTE 1301 TO MONUMENT SITE.

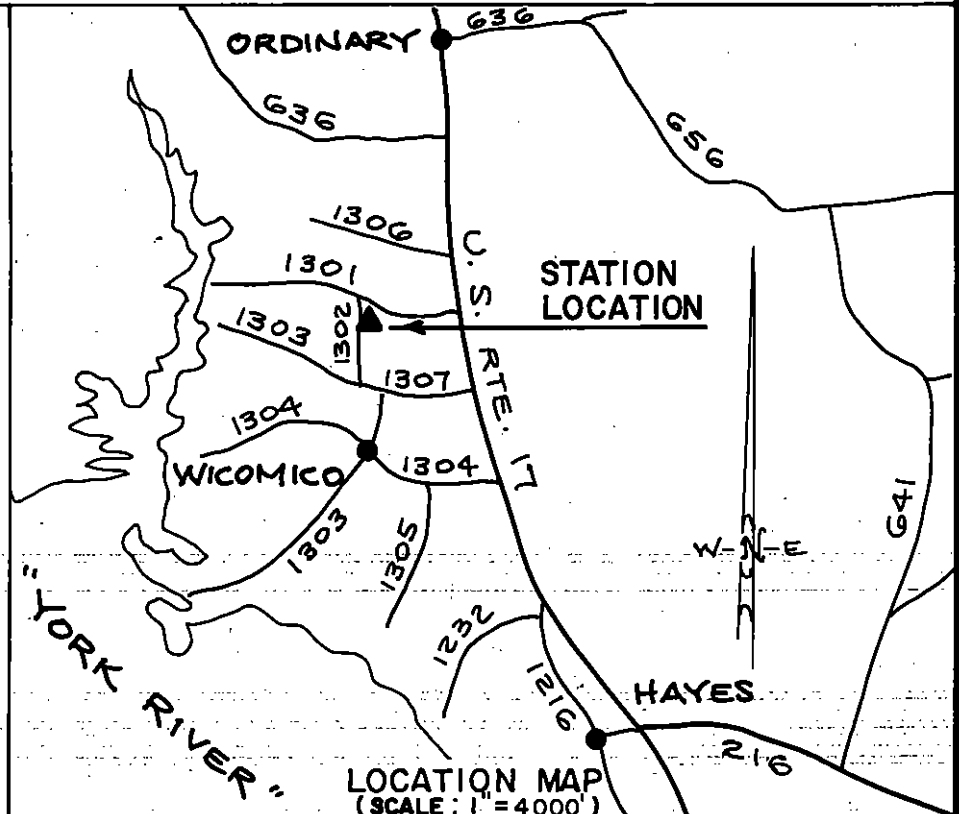
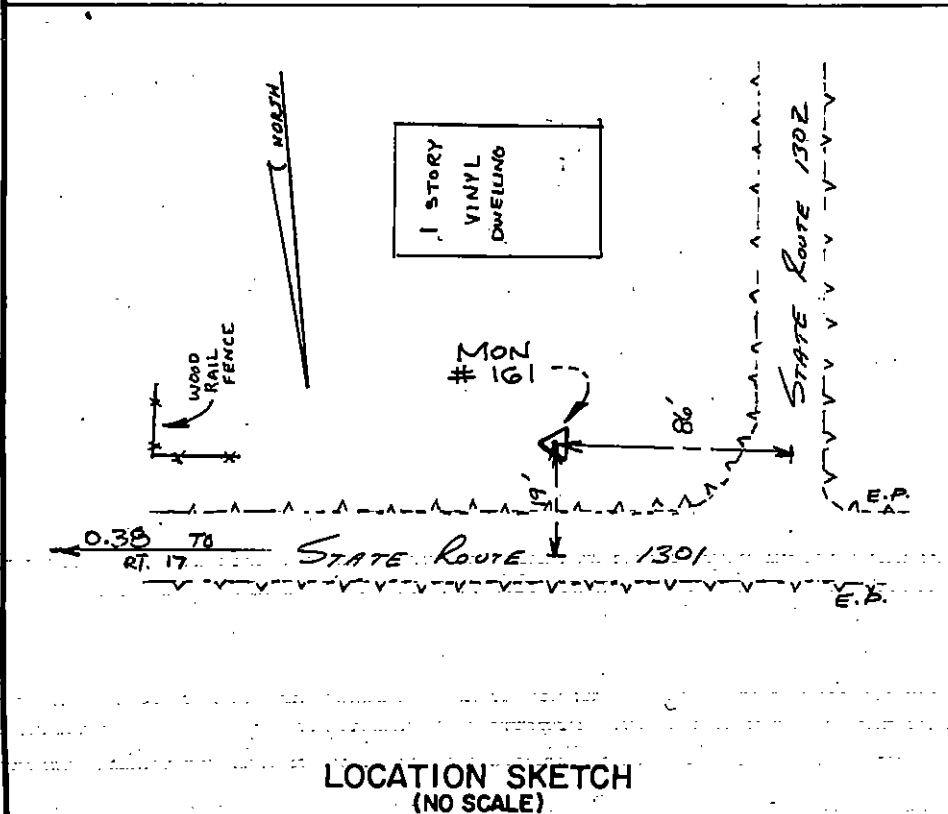

DATE: JANUARY, 1992

NOTE: USERS OF MONUMENTS LOCATED ON PRIVATE PROPERTY
MUST OBTAIN LAND OWNERS PERMISSION BEFORE ENTERING



DAWSON & PHILLIPS, P.C.
CERTIFIED LAND SURVEYORS
(004) 693-2993