

GLOUCESTER COUNTY SURVEY MARK DATA SHEET

STATION NO.

198

HORIZONTAL DATA :

VA. STATE PLANE COORD. - SOUTH ZONE (NAD 1983)

UNITS	EASTING (X)	NORTHING (Y)
METERS	3684343.653	1121336.866
U.S. SURVEY FT.	12087717.468	3678919.368
LATITUDE (DMS)	37 24 30.17810	
LONGITUDE (DMS)	76 25 3.06599	
SCALE FACTOR	0.99994566	
CONVERGENCE \sphericalangle (DMS)	1 15 50.06	

STATION DESCRIPTION :

DISTRICT : WARE

A 3 1/4" ALUMINUM DISK MONUMENT SET APPROXIMATELY FLUSH WITH THE GROUND STAMPED STATION NO. 198. TO REACH: FROM THE INTERSECTION OF STATE ROUTE 3 & 14 AND STATE ROUTE 623, GO ABOUT 3.0 MILES SOUTHEAST ON STATE ROUTE 623 TO INTERSECTION OF STATE ROUTE 623 AND STATE ROUTE 625, GO ABOUT 0.8 MILE EAST ON STATE ROUTE 625 TO INTERSECTION OF STATE ROUTE 625 AND STATE ROUTE 623, GO ABOUT 0.45 MILE NORTHEAST ON STATE ROUTE 625 TO PRIVATE GRAVEL ROAD THAT LEADS TO "THE ANCHORAGE", CONTINUE ABOUT 1.2 MILES NORTHEAST TO END OF PRIVATE GRAVEL ROAD AND MONUMENT SITE.

VERTICAL DATA :

REF. TO NATL. GEOD. VERT. DATUM (1988)

UNITS	STATION ELEVATION
METERS	0.68
U.S. SURVEY FT.	2.23

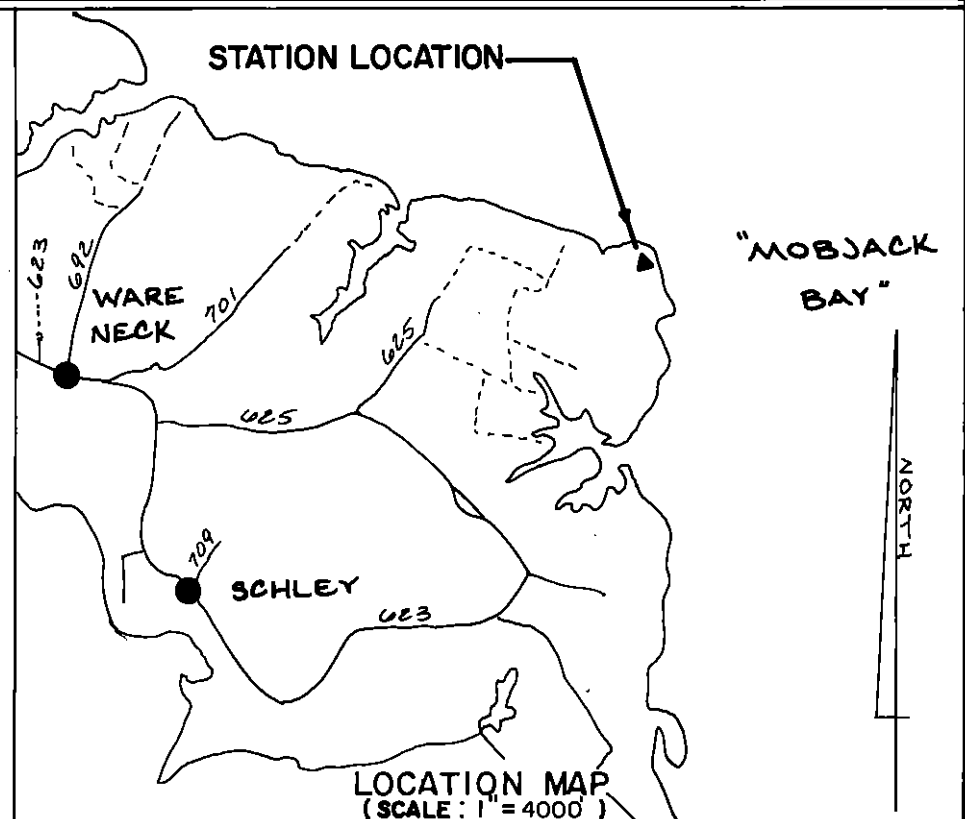
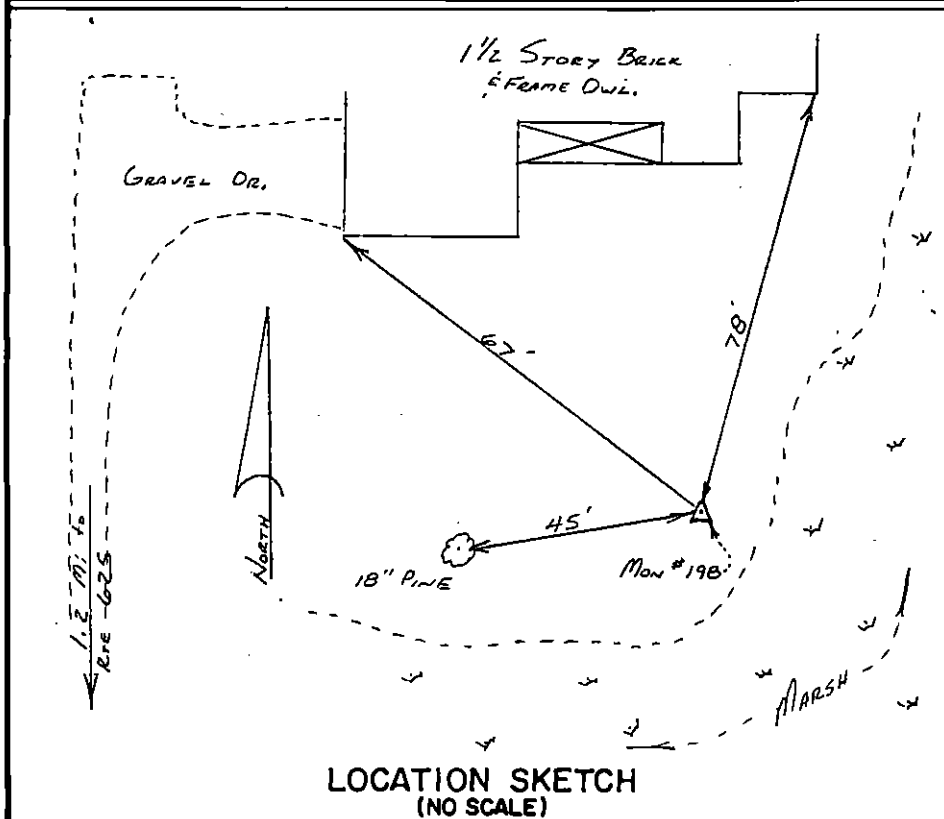

DATE: JANUARY, 1992

NOTE: USERS OF MONUMENTS LOCATED ON PRIVATE PROPERTY
MUST OBTAIN LAND OWNERS PERMISSION BEFORE ENTERING



DAWSON & PHILLIPS, P.C.

CERTIFIED LAND SURVEYORS
(804) 693-2993